

AERODROME CHART-ICAO ARP: 50°24'07"N 030°27'07"E ELEV 179 m TWR 120.700 GND 119.000 KYIV/Zhuliany

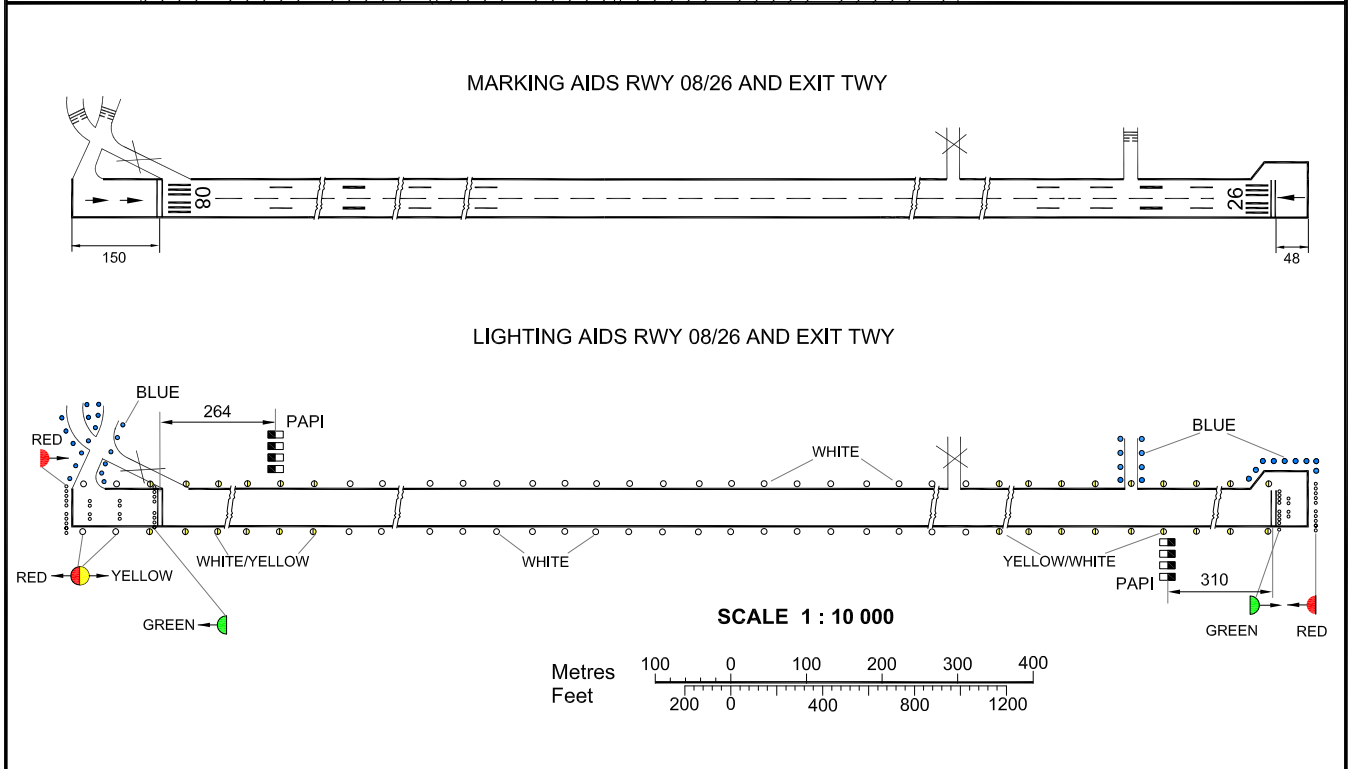
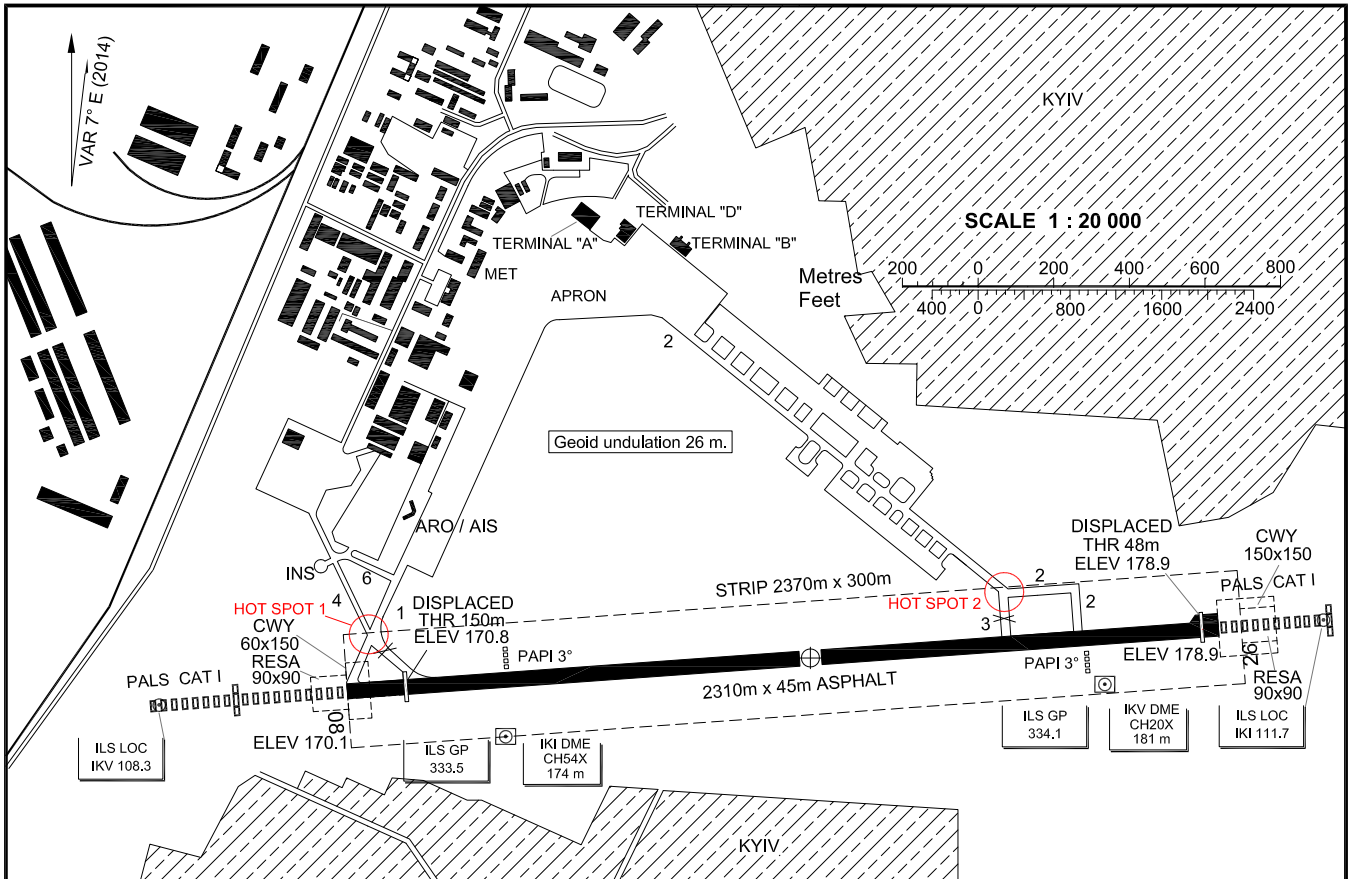

CHANGE: APRON; RWY SURFACE.

RWY	DIRECTION	THR	STRENGTH	AERODROME LIGHTING
08	079°	50°24'03.85"N 030°26'05.34"E	PCN 46/R/C/X/T	Approach: RWY 08/26 - LIH
DISPLACED THR 08		50°24'04.18"N 030°26'12.91"E		Runway: Edge - WHITE, last 600 m YELLOW - LIH
26	259°	50°24'08.85"N 030°28'02.07"E		Threshold: RWY 08/26 - GREEN
DISPLACED THR 26		50°24'08.75"N 030°27'59.65"E		Runway Edge lighting - RED, to displaced THR.

ELEVATIONS AND DIMENSIONS IN METRES
BEARINGS ARE MAGNETIC